



AN INVITATION TO JOIN THE CLOSTER NATURE CENTER

The Closter
Nature Center Association
P.O. Box 80,
Closter, NJ 07624
www.closternaturecenter.org

WE INVITE YOU TO JOIN

Any person or any family may join the Closter Nature Center Association. All are invited to take part in its activities.

MEMBERS OF THE NATURE CENTER RECEIVE:

- ...regular advanced notices of events taking place at the Center.
- ... priority registration and discounts for classes and the Summer Program.
- ...the satisfaction of helping to preserve this fine large tract of diverse natural habitats, and promoting its education goals.
- ...the opportunity to attend Trustee meetings and voice concerns or suggestions about the Center's operation.

ALL LOCAL RESIDENTS ARE OFFERED:

- ...informative lectures.
- ...nature walks for the general public or for school and scout groups.
- ...our unique Summer Program for children in grades PreK - 8.
- ...136 acres land including ponds, brooks, meadows and forests to explore.



**Express your support
by joining now!**

Type of Membership

(check one):

- Individual.....\$25.00
- Senior Citizen (65)..... \$25.00
- Family.....\$50.00
- Falcon\$75.00
- Eagle.....\$150.00
- Forest Steward\$500.00
- Life Individual.....\$1000.00

Would you be interested in volunteering occasionally?

Yes _____

No _____

Cut here and mail with check

MEMBERSHIP FORM

CLOSTER NATURE CENTER ASSOCIATION

www.closternaturecenter.org

Name _____

Address _____

City _____

State _____

Zip _____

Phone number _____

E-mail _____

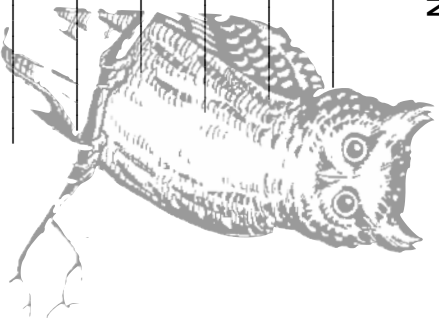

Make checks payable to Closter Nature Center Association and mail to:
P.O. Box 80, Closter, NJ 07624

WHAT IS THE CLOSTER NATURE CENTER?

It is, most importantly, an idea in the minds of the people of the community about the kind of place in which they want to live. It is 136 acres of ponds, brooks, meadows and forests maintained in a natural condition- in the center of Closter. It is a series of community happenings: group walks in the woods, evening family programs, and year-round classes for young people. It is individuals hiking, fishing, picnicking, photographing wild flowers, watching birds, and exploring. It is an association of people organized to promote all of these things.

A BRIEF HISTORY OF OUR CENTER

In 1961, the Mayor and Council, concerned that unwise development might erode the future quality of life in the borough, established a committee to study the prospects of a nature center. A report was prepared and a public association was incorporated in 1962. Originally the Borough leased approximately 80 acres to the association. Since that time more land has been added, some with the assistance of State and Federal Green Acres programs. A building for meetings and classes was erected in 1967. In 1985, the Nature Center lease was amended to place additional acres under Nature Center management and to extend the lease for 50 years. Closter is indeed fortunate in the foresight and timing of these acquisitions and in the variety of habitats thus preserved.

A CLOSER LOOK AT THE CLOSTER NATURE CENTER?

154 Ruckman Road, Closter, NJ

The map below shows the borough property leased to the Association. The different colors indicate marked trails for hikers.

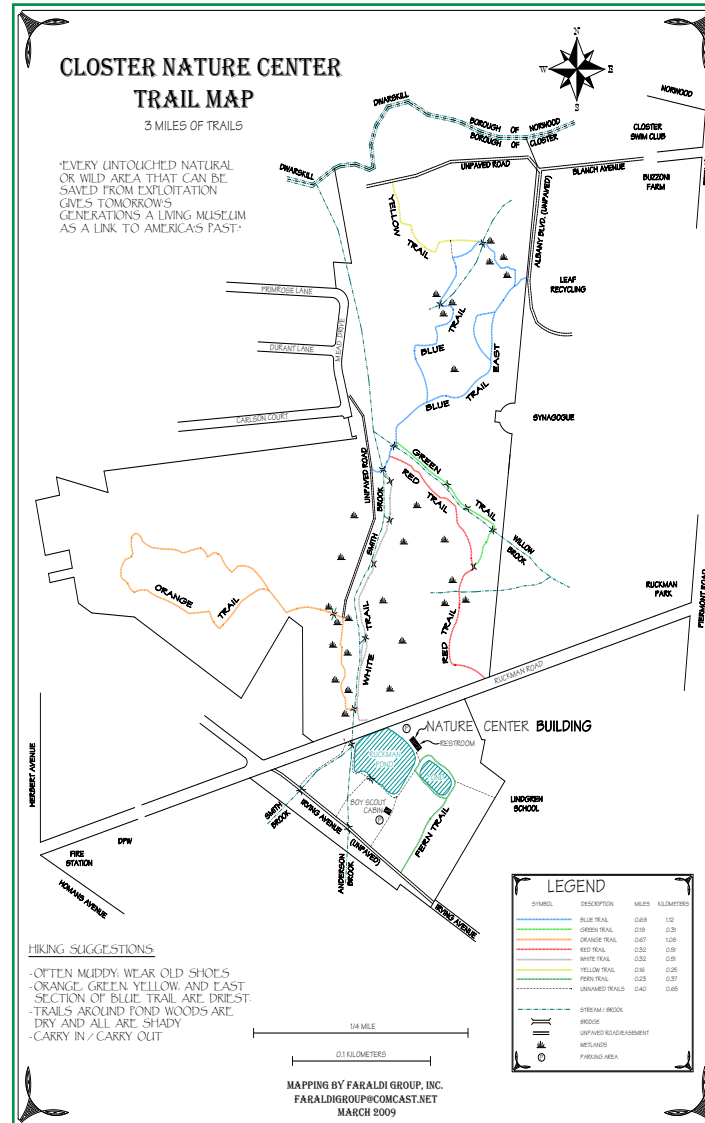

WHAT ARE THE OBJECTIVES OF THE NATURE CENTER ASSOCIATION?

CONSERVATION. To preserve for ourselves and our children this significant tract of land in its natural state, with all its diversity of plants and animals.

EDUCATION. To foster appreciation for the wonders of nature and understanding of how man and these natural systems are interrelated

RECREATION. To provide trails and facilities so that the land may be freely available for those who would use it to exercise, explore or simply relax.

The Closter Nature Center Association is governed by a Board of Trustees elected by the members and serving three-year renewable terms. The trustees meet in the Cabin the second Tuesday of the month at 8 PM. The public is welcome.

WE DEPEND ON YOUR SUPPORT! The Nature Center Association is an independent, non-profit organization whose programs, facilities, and trails are all managed by volunteers. Our paid Naturalist educates people of all ages at the Center and schools throughout the area. We are funded by membership dues, class fees, and donations. Closter's Open Space Fund provides support for major capital improvements. Your membership dues and extra support are our main source of income.

Special gifts from Mrs. S.A. Speake Maples and Mr. and Mrs. Henry H. Mandle enabled us to construct the Nature Center building.